

www.bilmak.com.tr

PROFESSIONAL & INNOVATIVE

S3072

Two-piece design

- * 304 stainless steel
- * 10 years color warrantee
- * Sealed electronics inside



Lock Dimension

S3072 lock panel size:

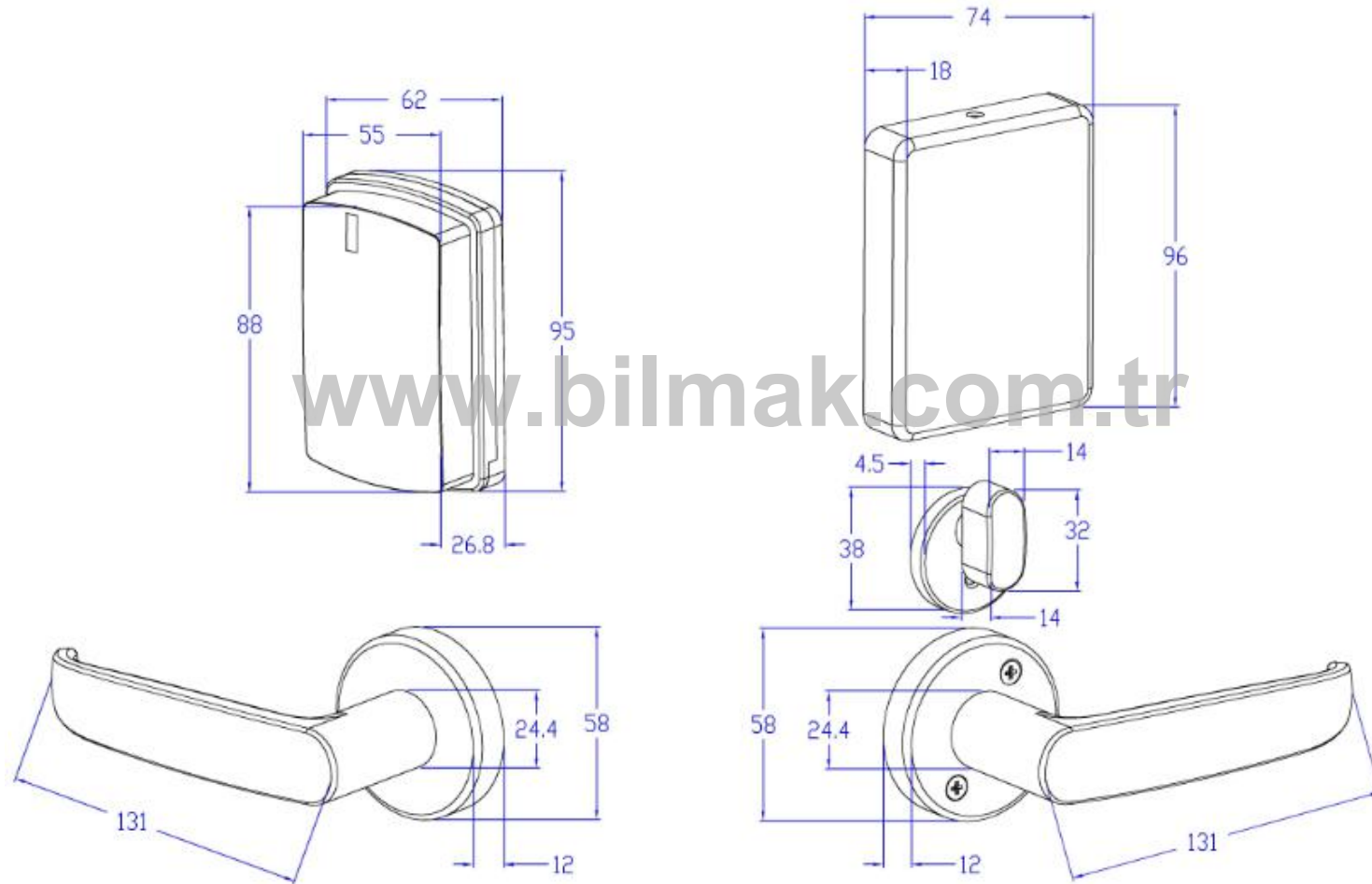

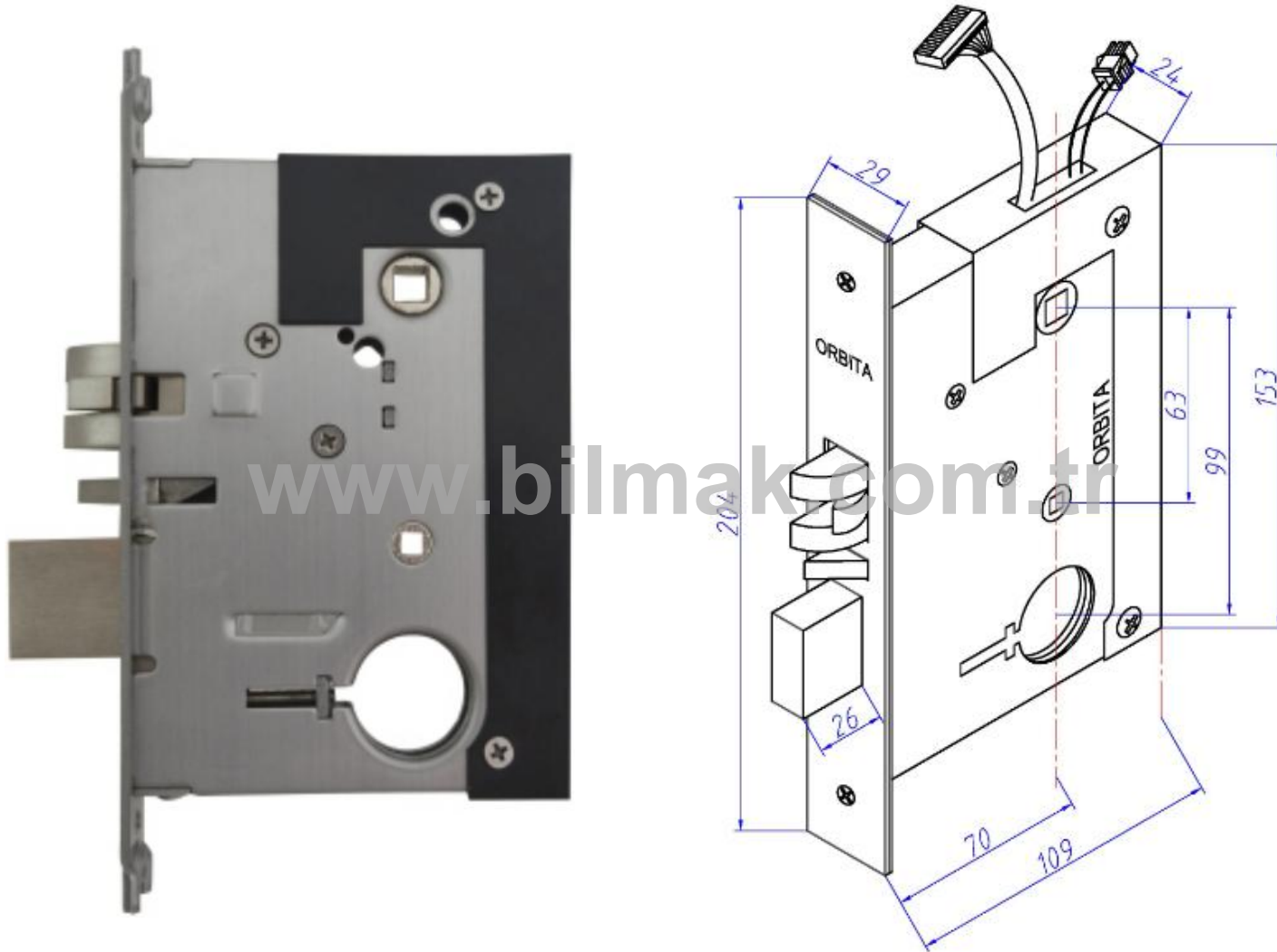

ANSI mortise, five latch, with deadbolt

Main Features & Function



- 304 Stainless Steel
- 5 latch ANSI U.S. standard mortise
- Hidden cylinder, override mechanical key
- 4 pc AA Alkaline battery
- Low Voltage warning.
- Mifare Technology
- Classified Access Authorization
- Master, Building master, Emergency card, House keeping card...
- Lost card suspension.
- Common door function like Swimming pool, Gym, fitness center.
- Meeting room function
- 210 pcs opening records



- Step by step user friendly software
- Software operation records.
- Classified operating authorization.
- Download the lock opening records.
- Support Winxp,win7, win8, vista.
- Support 32/64 digit system.
- Interface with major PMS, such as FIDELIO/OPERA.
- Suspend lost card, blacklist certain users.

www.bilmak.com.tr



- Wireless
- Program lock
- Read & update lock time
- Download & read Events
- Open lock as master key

www.bilmak.com.tr

Drilling for Installation

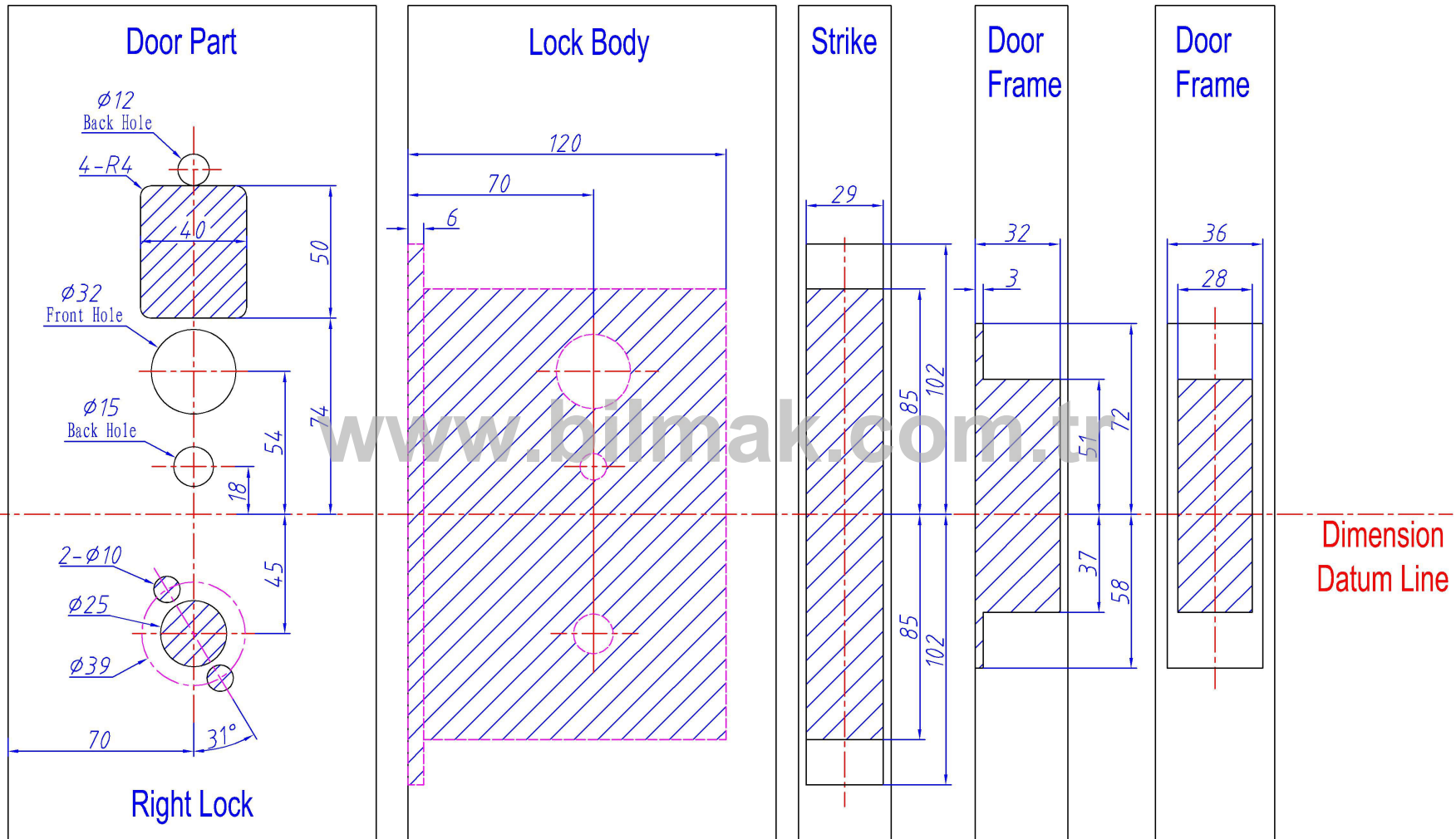

- Note:**
1. The continuous thick line parts are to be drilled, pls refer to the picture dimensions.
 2. Centerline of lock body is the dimension datum line.
 3. Dimension unit: mm.
 4. The carmine dot line part is lock body, the continuous thin line part is door part.

Hole Drilling Sketch

Models: S3072, S3172

Drawer

Assessor

Orbita Technology Co.,LTD

Classic References (include but not limited)

- ✓ Beach side hotels & Resorts
- ✓ Cruise Ship
- ✓ University Dormitory
- ✓ Hotels with doors exposed outside.
- ✓ Coastal area or Island.
- ✓ Area with high humidity.

